

FIRST FLOOR PLAN

LEGEND - FALSE CEILING	
	GYPSUM CEILING @LVL. 2450
	GYPSUM CEILING @LVL. 2500
	G.I GRID CEILING @ LVL. 2550

- NOTES:**
1. THIS DRAWING IS ISSUED FOR VALIDATION ONLY AND SHOULD BE USED ONLY FOR THE PURPOSE IT IS ISSUED FOR.
 2. ALL DIMENSIONS ARE FROM FINISHED TO FINISHED SURFACES.
 3. DO NOT SCALE THIS DRAWING.
 4. ALL DIMENSIONS ARE IN MM.

MITIMITRA CONSULTANTS PVT.LTD. HOLDS THE COPYRIGHT OF THIS DESIGN AS PER THE INDIAN COPY RIGHT ACT, 1957 CLAUSE NO 17 & 18 IN THE CAPACITY OF THE AUTHOR. THIS DRAWING SHOULD NOT BE COPIED, REPRODUCED OR USED WITHOUT THE EXPRESS PERMISSION OF MCPL.

ISSUED ON	ISSUED TO	ISSUED FOR	COPIES
	JOB NO: SBI06	DRAWING NO: 06R0/TPin06	DATE: 09/09/2024
	DRAWN BY: PK	CHECKED BY: RJ	SCALE: N.T.S

PROJECT:
PROPOSED INTERIOR DESIGN SCHEME OF NEW SBI LOCAL HEAD OFFICE AT KHARADI, PUNE.

MITIMITRA CONSULTANTS
 ARCHITECTS, INT & LANDSCAPE DESIGNERS & GOVT.APPRD. VALUERS
 1st Floor, "ARTHA BODHI" - 968/21-22, Senapati Bapat Road, Pune - 411 016.
 TEL - 25650218, 65220218 FAX - 25651228 E-MAIL- mitimitra@gmail.com

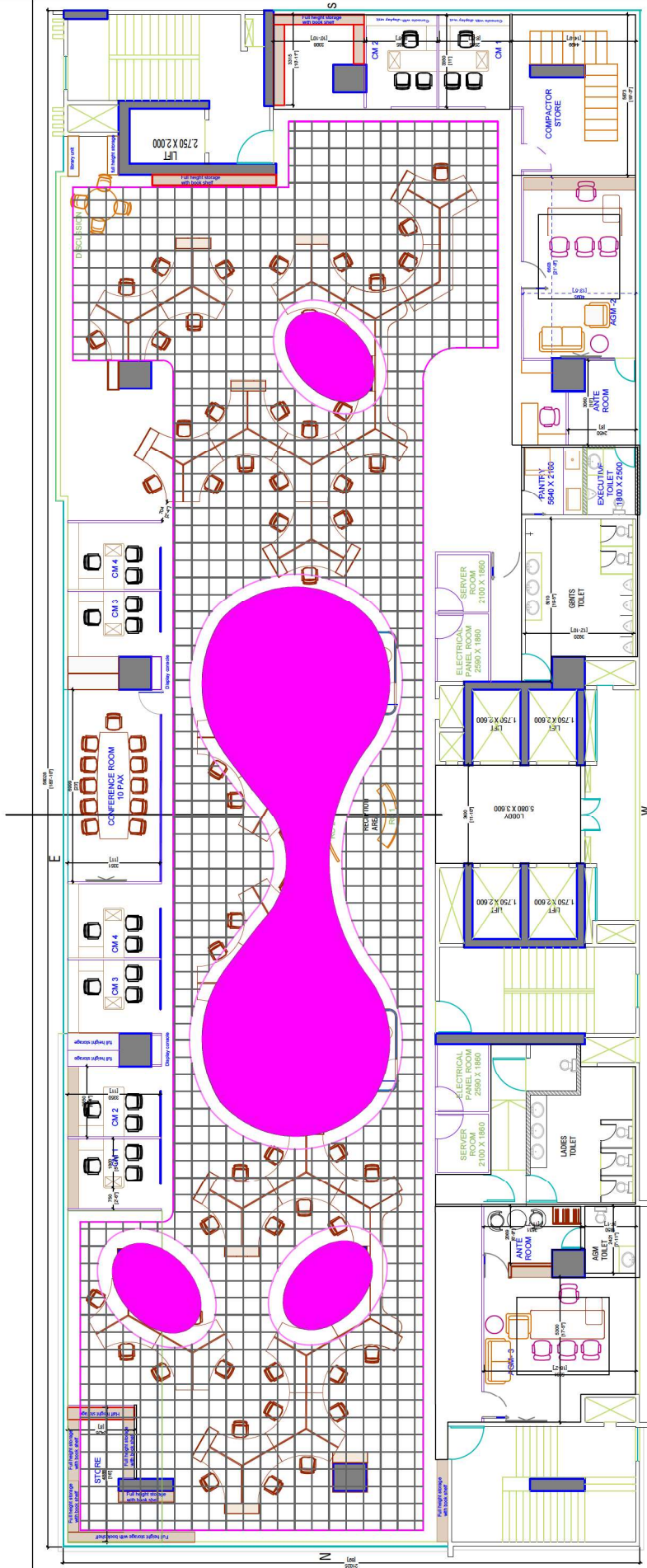

SECOND FLOOR PLAN

LEGEND - FALSE CEILING	
	GYPSUM CEILING @LVL. 2450
	GYPSUM CEILING @LVL. 2500
	G.I GRID CEILING @ LVL. 2550

- NOTES:**
- THIS DRAWING IS ISSUED FOR VALIDATION ONLY AND SHOULD BE USED ONLY FOR THE PURPOSE IT IS ISSUED FOR.
 - ALL DIMENSIONS ARE FROM FINISHED TO FINISHED SURFACES.
 - DO NOT SCALE THIS DRAWING.
 - ALL DIMENSIONS ARE IN MM.

MITIMITRA CONSULTANTS PVT.LTD. HOLDS THE COPYRIGHT OF THIS DESIGN AS PER THE INDIAN COPY RIGHT ACT, 1957 CLAUSE NO 17 & 18 IN THE CAPACITY OF THE AUTHOR. THIS DRAWING SHOULD NOT BE COPIED, REPRODUCED OR USED WITHOUT THE EXPRESS PERMISSION OF MCPL.

ISSUED ON	ISSUED TO	ISSUED FOR	COPIES
	JOB NO: SBI06 DRAWN BY: PK	DRAWING NO: 06R0/Tpin06 CHECKED BY: RJ	DATE: 16/08/2024 SCALE: N.T.S

PROJECT:
PROPOSED INTERIOR DESIGN SCHEME OF NEW SBI LOCAL HEAD OFFICE AT KHARADI, PUNE.

MITIMITRA CONSULTANTS
 ARCHITECTS, INT & LANDSCAPE DESIGNERS & GOVT.APPRD. VALUERS
 1st Floor, "ARTHA BODHI" ,968/21-22, Senapati Bapat Road, Pune-411 016.
 TEL - 25650218, 65220218 FAX - 25651228 E-MAIL- mitimitra@gmail.com



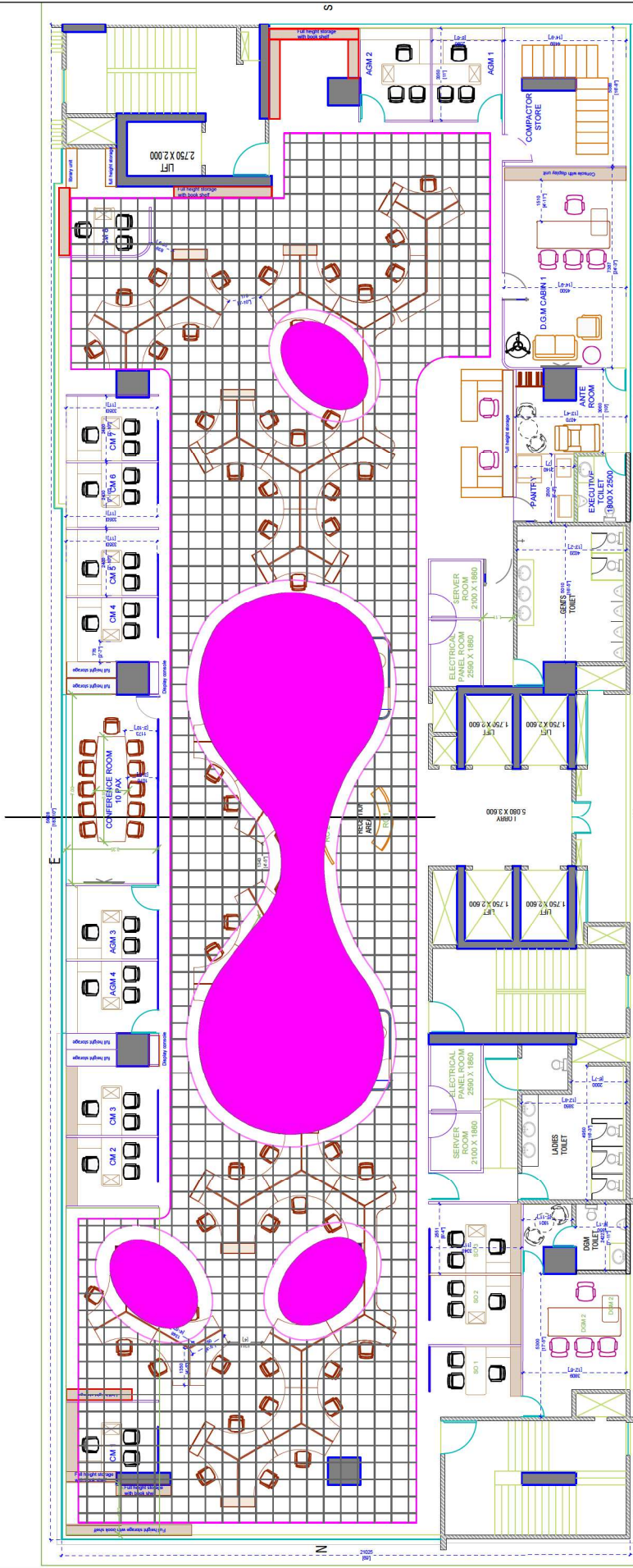

THIRD FLOOR PLAN

LEGEND - FALSE CEILING	
	GYPSUM CEILING @LVL. 2450
	GYPSUM CEILING @LVL. 2500
	G.I GRID CEILING@ LVL. 2550

NOTES:

1. THIS DRAWING IS ISSUED FOR VALIDATION ONLY AND SHOULD BE USED ONLY FOR THE PURPOSE IT IS ISSUED FOR.
2. ALL DIMENSIONS ARE FROM FINISHED TO FINISHED SURFACES.
3. DO NOT SCALE THIS DRAWING.
4. ALL DIMENSIONS ARE IN MM.

MITIMITRA CONSULTANTS PVT.LTD. HOLDS THE COPYRIGHT OF THIS DESIGN AS PER THE INDIAN COPY RIGHT ACT, 1957 CLAUSE NO 17 & 18 IN THE CAPACITY OF THE AUTHOR. THIS DRAWING SHOULD NOT BE COPIED, REPRODUCED OR USED WITHOUT THE EXPRESS PERMISSION OF MCPL.

ISSUED ON	ISSUED TO	ISSUED FOR	COPIES
	JOB NO: SBI06	DRAWING NO: 06R0/TPin06	DATE: 16/08/2024
	DRAWN BY: PK	CHECKED BY: RJ	SCALE: N.T.S

PROJECT:
PROPOSED INTERIOR DESIGN SCHEME OF NEW SBI LOCAL HEAD OFFICE AT KHARADI, PUNE.

MITIMITRA CONSULTANTS
 ARCHITECTS, INT & LANDSCAPE DESIGNERS & GOVT.APPRD. VALUERS
 1st Floor, "ARITHABODHI" ,968/21-22, Senapati Bapat Road,Pune-411 016.
 TEL - 25650218, 65220218 FAX - 25651228 E-MAIL- mitimitra@gmail.com